

Daily • Diariamente • 日常维护

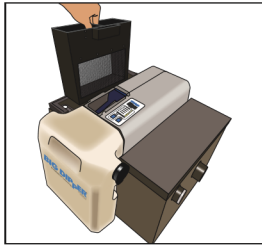

1

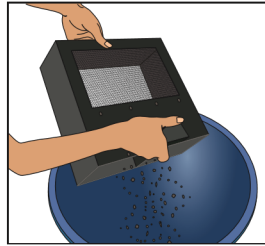

2

Daily

1 & 2 - Remove solids strainer basket and empty into trash. Spray down solids strainer basket.
3 & 4 - Empty collected grease into recycling barrel or dispose in trash.

Diariamente

1 & 2 - Vacíe los residuos alimenticios capturados en el cedazo/canasta en un recipiente para basura. Enjuague el cedazo/canasta después de vaciarlo.
3 & 4 - Vacíe la grasa recolectada en el barril de reciclaje.

每日一次

1 & 2 - 把滤网里的残渣倒入垃圾桶，并将滤网冲洗干净。
3 & 4 - 将废油收集桶中的废油倒入废油回收桶。

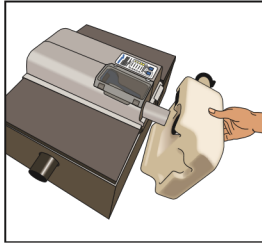

3

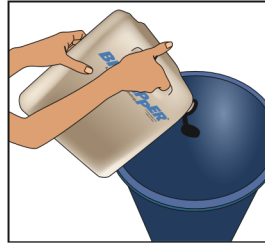

4

Weekly • Semanalmente • 每周维护

Weekly

1 - Open Wiper Assembly Cover.
2 & 3 - Remove and clean blue wiper assembly.
4 - Replace wiper assembly. Clean grease outlet trough.

Semanalmente

1 - Levante la cubierta de las aspas limpiadoras.
2 & 3 - Remueva y limpie las aspas azules.
4 - Regrese las aspas azules y limpie el canal de la salida de la grasa.

每周一次

1 - 打开污水箱盖。
2 & 3 - 清洁括油刀片。
4 - 清洁废油出口处。

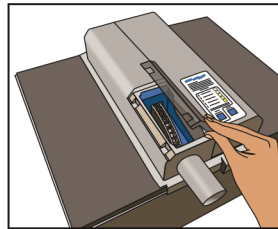

1

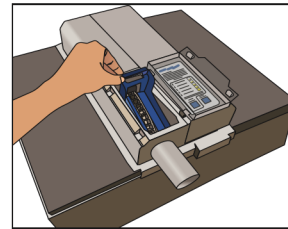

2

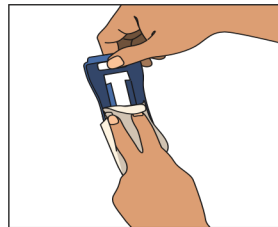

3

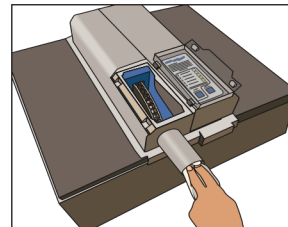

4

Quarterly • Trimestral • 每月维护

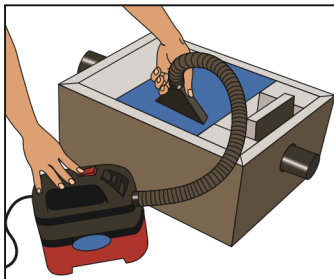

Quarterly

1 - Vacuum out fine sediment from bottom of tank OR stir up sediment at bottom of tank with long handled spoon while water is running through unit.

Trimestral

1 - Aspire los sedimentos finos del fondo del tanque O agite estos sedimentos con una cuchara de mango largo mientras el agua esta corriendo através de la unidad.

每月一次

1 - 用真空器吸出箱底的沉淀物，或用长柄勺子搅动箱底的沉淀物，同时以清水将其冲出。